

Injector/extractor handles

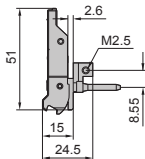

Injector/extractor handle type VII

Plastic (telecom)

For inserting and removing connectors with a large number of pins. This handle was specifically designed for use in telecom applications.

- Insertion/removal function
- Optionally with 1/2 HP offset PCB attachment, e.g. for component mounting on both sides
- Minimum front space requirements, due to fold-up handle
- Codeable
- Optional integral micro-switch for "live insertion" applications
- ESD pin to dissipate static charges prior to making contact with the connectors and for precise positioning of the board type plug-in unit
- Large labelling area on the front.

Material:
Plastic

Supply includes:
Assembly parts.

Note:
Insertion only when used with front horizontal rails, with 10 mm extension (B),

Handles without offset

Installation	Packs of	Model No. RP
top	1	3688.784
bottom	1	3688.785

Handles with 1/2 HPoffset

Installation	Packs of	Model No. RP
top	1	3688.780
bottom	1	3688.781



Accessories:

Keys, See Page 131

Micro-switches, See Pages 143 or 144

Connector pin for buying, See Page 142

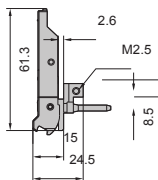

Injector/extractor handle type VII

Metal (telecom)

For inserting and removing connectors with a large number of pins (up to 815 N). This handle was specifically designed for use in telecom applications.

- Insertion/removal function
- Optionally with 1/2 HP offset PCB attachment, e.g. for component mounting on both sides
- Minimum front space requirements, due to fold-up handle
- Codeable
- Optional integral micro-switch for "live insertion" applications
- ESD pin to dissipate static charges prior to making contact with the connectors and for precise positioning of the board type plug-in unit
- Metal design for use in aggressive atmospheres.

Material:
Die-cast zinc

Supply includes:
Assembly parts.

Note:
Insertion only when used with front horizontal rails, with 10 mm extension (B),

Handles without offset

Installation	Packs of	Model No. RP
top	1	3688.790
bottom	1	3688.791

Handles with 1/2 HPoffset

Installation	Packs of	Model No. RP
top	1	3688.786
bottom	1	3688.787



Accessories:

Keys, See Page 131

Micro-switches, See Page 143 or 144

Connector pin for buying, See Page 142



Micro-switch

For "live insertion" applications. Installation in injector/extractor handles, types IV, IVs and VII. May also be retrofitted.

Technical specifications:
Switching load: 50 mA 30 V DC
Service life/switching cycles:
At nominal load: 30,000
mechanical: 50,000

Packs of	Model No. RP
10	3684.410



Also required:

Micro-switch mounting clip, See Page 144